



EUROPEAN
SEALING
TECHNOLOGY

Seals for industry

BAGUES D'ETANCHEITES

TYPE AS DIN3760





Profil Standard selon DIN3760

Profil	Désignation	Profil	Désignation
	Type : A		Type AS
	Type B		Type BS
	Type C		Type CS

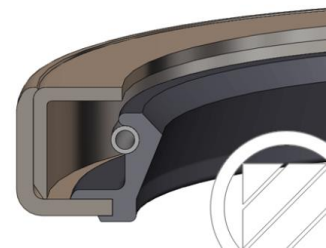
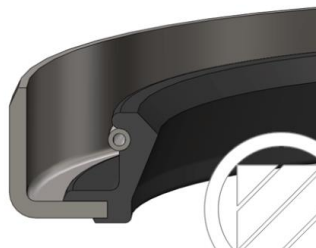
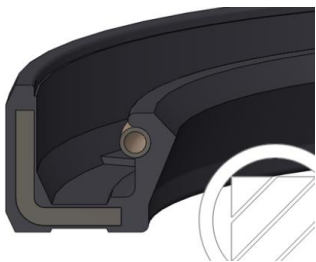



Oil seal Type AS are radial oil seal with completely rubber covered outer diameter, spring-loaded sealing lip and an additional dust lip which prevent the introduction of dust and dirt from the outside.

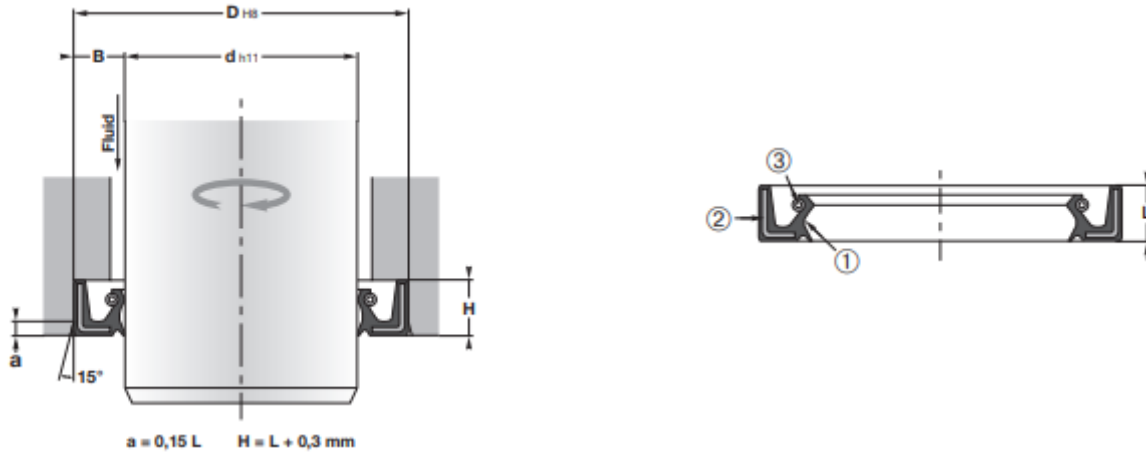

Operating conditions:

Pressure	$\leq 0,05$ MPa
Temperature NBR	-30°C to 100°C
Temperature FPM	-20°C to 200°C
Speed	3 to 10 m/s
Fluids	Mineral oils, water emulsions
Shaft surface hardness	≥ 55 HRC
Shaft hardness depth	$\geq 0,3$ mm

Materials

Seal	NBR or FPM
Metal cage	Steel
Spring Standard	Steel, On demand: Stainless steel

Assembly: Open groove