



EUROPEAN  
SEALING  
TECHNOLOGY  

---

Seals for industry

---

## BAGUES D'ETANCHEITES

### TYPE A DIN3760

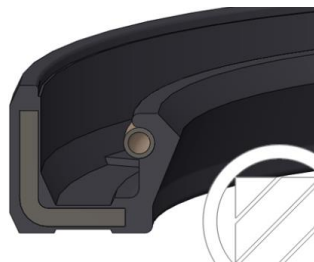



## Profil Standard selon DIN3760

Profil	Désignation	Profil	Désignation
	Type : A		Type AS
	Type B		Type BS
	Type C		Type CS

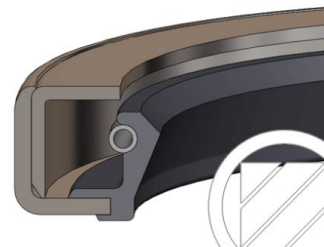
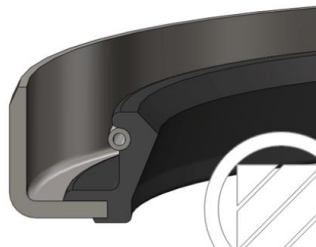
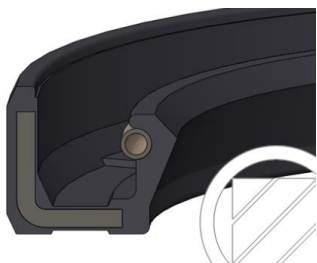



**Oil seal Type A** are oil seal with completely rubber covered outer diameter and a spring-loaded sealing lip. This type is not recommended for use in heavily polluted applications

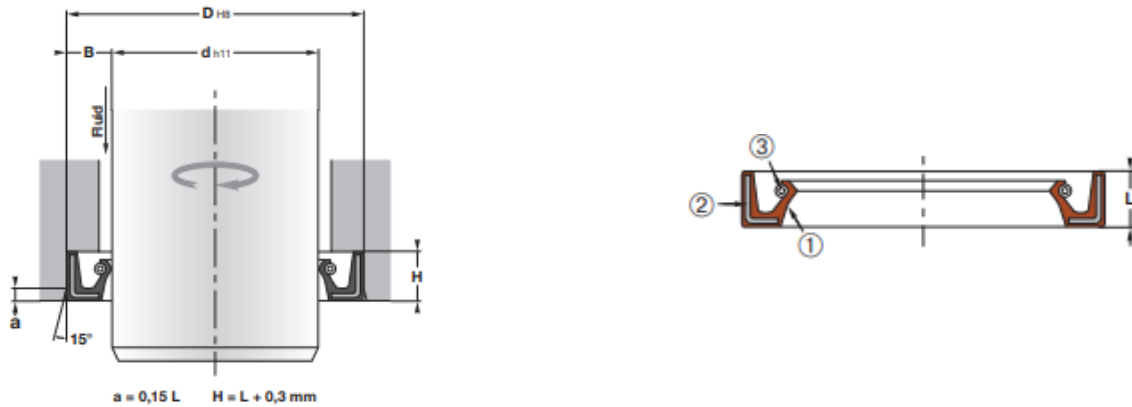

Operating conditions:

Pressure	≤ 0,05 MPa
Temperature NBR	-30°C to 100°C
Temperature FPM	-20°C to 200°C
Speed	3 to 10 m/s
Fluids	Mineral oils, water emulsions
Shaft surface hardness	≥ 55 HRC
Shaft hardness depth	≥ 0,3 mm

Materials

Seal	NBR or FPM
Metal cage	Steel
Spring Standard	Steel, On demand: Stainless steel

Assembly: Open groove